

# 1 kV Branch Joint with Fuse BMP

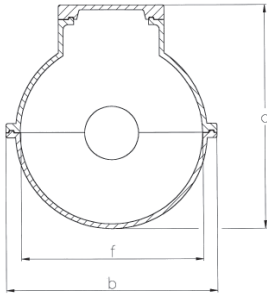

resin technique



**BMP 820/190**

for paper insulated cables

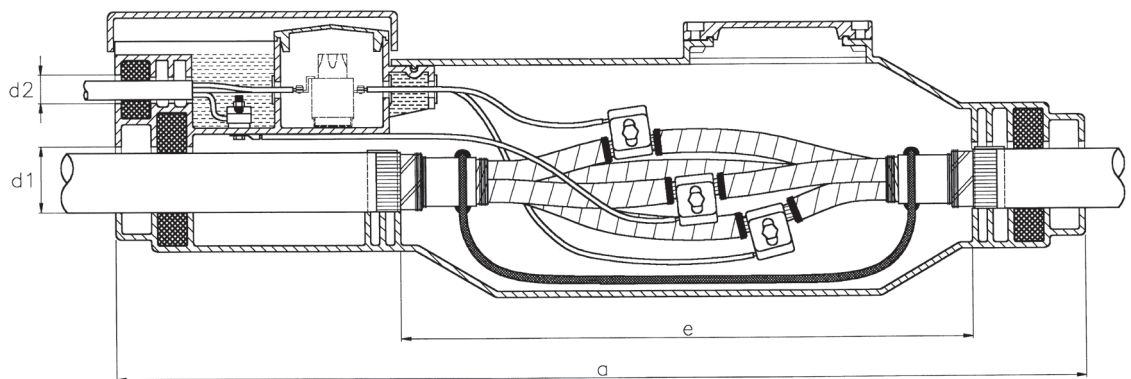

Type	Dimensions in mm approx.							Volume in Litre app.
	a	b	c	d1	d2	e	f	
<b>BMP 820/190</b>	815	220	235	22	55	480	190	15

The shell is made of a torsion-stiff, heat resistant and impact resistant plastic. When assembling on N(A)KBA cables the use of earthing sets is possible. See to section 8 "cable connectors".

Type	Max. Cross Section Main Cable (mm <sup>2</sup> )		Max. Cross Section Branch Cable (mm <sup>2</sup> )	
<b>BMP 820/190</b>	N(A)KBA NAKLEY	3 x 185 3 x 150	N(A)YY N(A)YCWY	4 x 16 3 x 16/16

## Handling

The upper part of the shell is two-part so that a simple mounting is ensured.

The fuse-box is integrated in the upper shell and is pre-mounted with connecting wires. This allows the installation without switching off the main cable voltage.

The fuses are accessible from the outside.

## Application

The joint box is suitable for use with all available cable ring connectors and single clamps.

As the shell is made of heat resistant plastic it is possible to use hot pouring compounds.

## Specification

- three-part shell with fuse-box
- fuses
- sealings
- assembly material
- cast resin for fuse-box
- installation instructions
- without sealing compound

Alternative accessories according to your requirements is possible.